

Release 3.1.8 Eclipse Mobile Feature Summary & Release Notes

Use the following release notes to ascertain what issues have been resolved and the feature summary listing to see what new functionality has been added with Eclipse Mobile Release 3.1.8.

Feature Summary for 3.1.8

The following are now available:

- **Prospects** – When creating a new prospect, to set the appropriate branches and settings, the system reads the customer template set on the **New Customer Maintenance Template** control record. The system uses the logged user home branch to select the appropriate template.
- **Messages** – Users can delete sent or received messages.

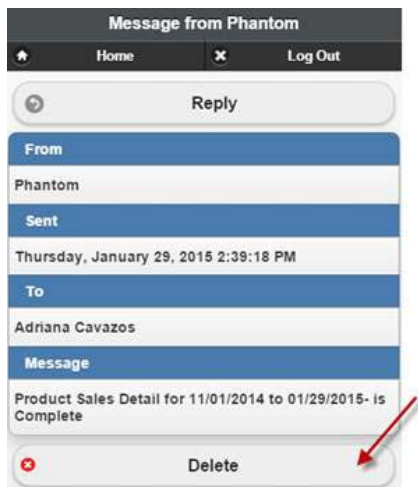

- **Cart** – When creating a new cart or editing an existing one, the Order Entry messages set in Customer Maintenance now display in Mobile. When the bill-to or ship-to customer on the cart has an Order Entry message set, a new button displays, allowing the user to read the OE message at any time.

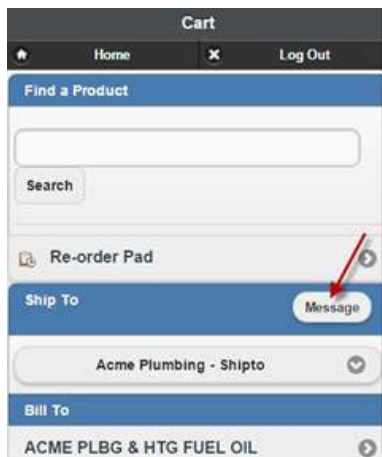

- **Activities** – The new **Add Activity** button in **Order Summary** displays the **New Activity** page for Ship-To Customer. Use this option to quickly add a new customer activity for the Ship To Customer of the order.
The Activity log option is now called Order Activity.

Order S001741858

Home Log Out

Bill To: [ACME PLBG & HTG FUEL OIL](#)
1149 HARTFORD AVENUE LINE2222 JOHNSTON, RI 02919-7108

Ship To: [Acme Plumbing - Shipto](#)
123 Main Street LINE 2222 BOULDER, CO 80302-8761

Price Branch: LosAngeles 2 Ship Branch: LosAngeles 2

Ship Via: BR2 Source: MOE

Order Date: 2/13/2015 Required Date: 2/13/2015

Primary Salesperson: [Diana Mitchell 38263](#) Secondary Salesperson: [Diana Mitchell 38263](#)

Job: Add Opportunity: Add

Writer: [Adriana Cavazos](#) Signature: Sign

Order Activity: View Customer Activity: Add

Qty	Description	Unit	Extended
1ea	WQE-02 California Faucets - Deluxe Shower Drain Trim	\$9.50/ea	\$9.50

Release Notes for Release 3.1.8

The following issues are resolved with this release:

- **Contacts** – Contacts specified at the Bill To level now display on all related ship-to customers on the **Ordered By** field in the Checkout page.

PO Number: P005637

Release Number: 002

Ordered By: Eric Draven

Eric Draven
Shelly Webster

Payment Information

Select a payment method: Pay without credit card

- **Sales Budget** - When drilling into the Sales Budget information of a bill-to customer, you can toggle between the bill-to customer or the bill-to customer and associated ship-tos. By default, the system displays the information for the bill-to customer and all its associated ship-to accounts.

Sales Budget Details			
View Bill-To Only		View Bill-To and associated Ship-To accounts	
2015 Sales budget for Adriana JM Bill To		2015 Sales budget for Adriana JM Bill To	
(Bill-To and associated Ship-Tos)		(Bill-To Only)	
Projected Sales	\$30,000.00	Actual Sales	\$2,600.00
Projected Gross Profit	\$12,450.00	Actual Gross Profit	\$1,705.00
Last Year's Projected Sales	\$0.00	Last Year's Actual Sales	\$0.00
Last Year's Projected Gross Profit	\$0.00	Last Year's Actual Gross Profit	\$0.00
Sales Budget Groups			
WOE-01 - Luxury copper faucet			
Projected Sales: \$3,000.00		Projected Gross Profit: \$1,200.00	

- **YTD/Monthly Sales Graphs** - YTD and Monthly Sales charts now graph negative amounts below zero.

